

MARC BRANDT PARK INFILTRATION BASINS

Public Meeting
May 9, 2026

Agenda

1. Project Team
2. Introduction
3. Existing Conditions
4. Alternatives Analysis
5. Proposed Improvements
6. Green Stormwater Infrastructure (GSI)
7. Planting Style
8. Conceptual Place Making
9. Next Steps

Project Team



CITY OF SANTA FE
PARKS & OPEN SPACE



Dekker
Architecture in Progress

Introduction

» Project Overview

» Proposed Improvements

Park Features

- » Improved landscaping using native and drought-tolerant plantings
- » Enhanced accessibility and pedestrian connections
- » A design that maintains the park as a functional, usable community space

Stormwater Improvements

- » New multi-use infiltration areas to manage stormwater during rain events
- » Improved drainage patterns to safely capture and convey water



Existing Conditions



Avenida De Las Campanas



Proposed Improvements

» Site Map

- » 2.2 acres of at-grade park
- » 2.6 acres of multi-use stormwater infiltration areas

5 Year Inundation



Proposed Improvements

- » Incorporate GSI Elements and Locally Adapted Plants



Proposed Improvements

» 100-Year Storm Hydraulic Performance

- » Inflow: 514 cfs
- » Outflow: 200 cfs
- » Total Storage Volume: 9.1 ac-ft

» Downstream Impacts

100 Year Inundation



Proposed Improvements

**5 Year
Inundation**



**25 Year
Inundation**



**50 Year
Inundation**



Questions?

Green Stormwater Infrastructure (GSI) & Conceptual Place Making



Green Stormwater Infrastructure (GSI)

RAIN GARDEN SYSTEM



WHAT IS A RAIN GARDEN?

Rain gardens are shallow, vegetated systems designed to capture and infiltrate stormwater runoff from adjacent surfaces such as streets, sidewalks, and rooftops.

By slowing down water flow, filtering pollutants, and allowing infiltration into the soil, rain gardens reduce flooding, improve water quality, and recharge groundwater.

Integrated with native plantings and pedestrian spaces, they provide both ecological function and aesthetic value within urban environments.



BENEFITS



WATER QUALITY
Filters pollutants and sediments, improving downstream water quality



FLOOD MITIGATION
Reduces runoff volume and peak flows, helping prevent flooding



HABITAT CREATION
Supports native plants, pollinators, and urban biodiversity



URBAN COOLING
Adds greenery that reduces heat island effect and improves human comfort

Green Stormwater Infrastructure (GSI)

PERMEABLE CONCRETE

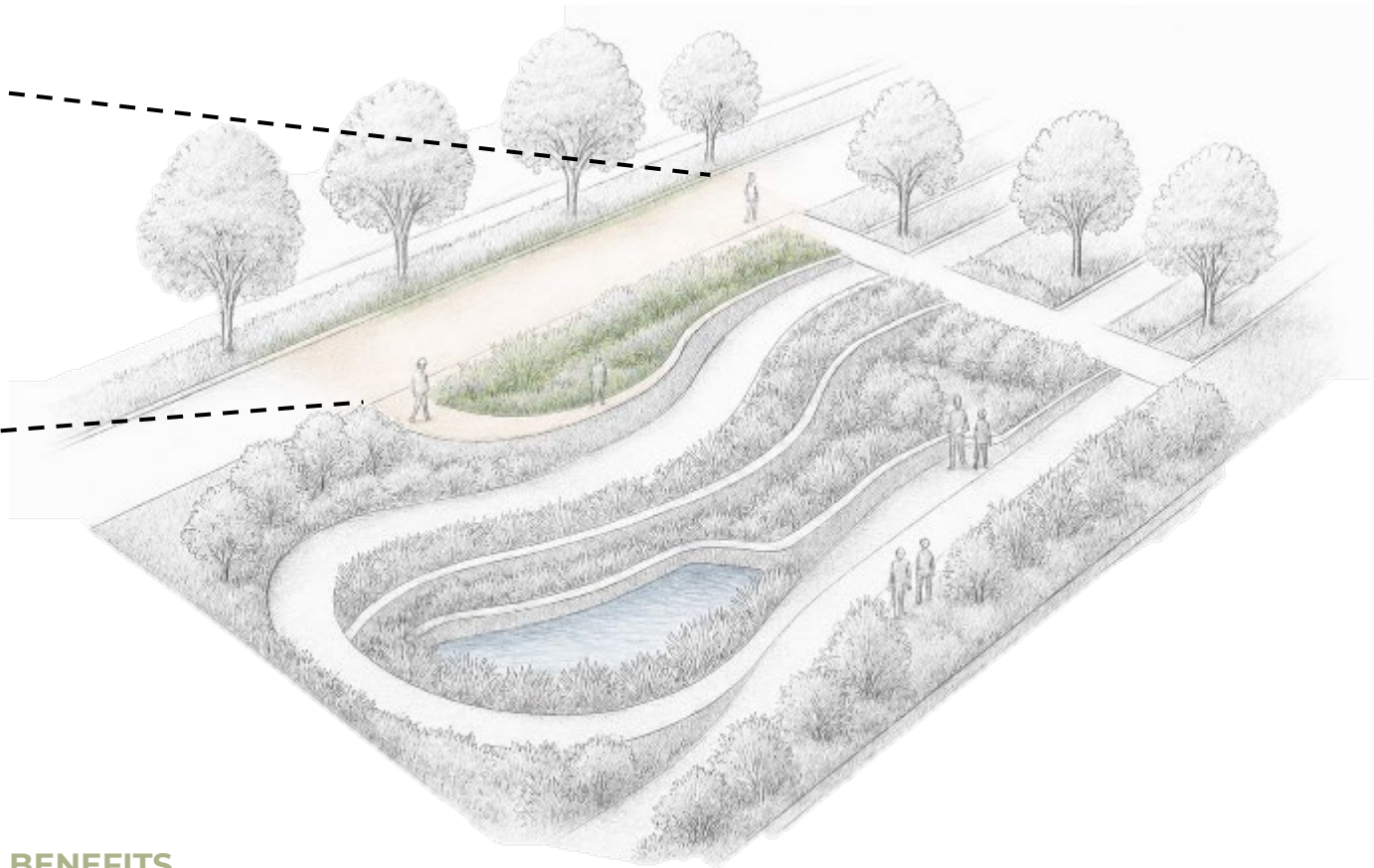
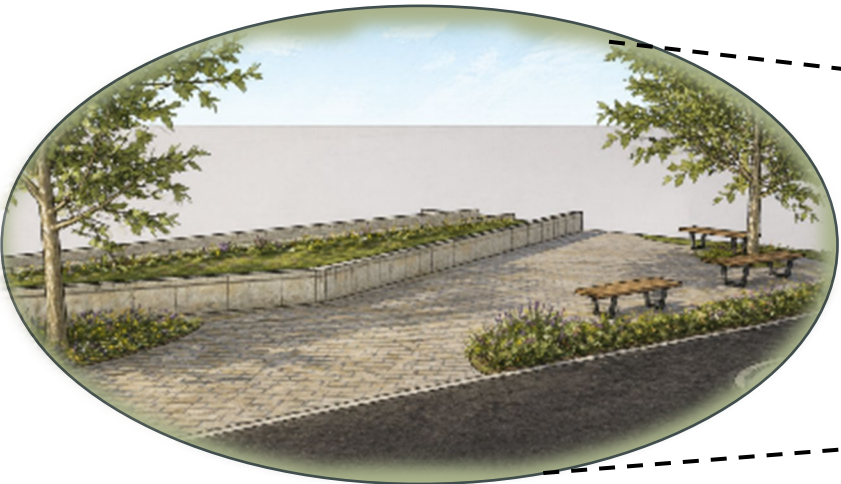

WHAT IS PERMEABLE CONCRETE?

Permeable concrete allows rainwater to pass through its porous surface, reducing runoff, replenishing groundwater and improving water quality- while providing durable, low maintenance surfaces for our streets and public spaces.



BENEFITS

WATER QUALITY
Filters pollutants and sediments, improving downstream water quality



FLOOD MITIGATION
Reduces runoff volume and peak flows, helping prevent flooding



HABITAT CREATION
Supports native plants, pollinators, and urban biodiversity



URBAN COOLING
Adds greenery that reduces heat island effect and improves human comfort

Green Stormwater Infrastructure (GSI)

BIO SWALES AND BIO INFILTRATION

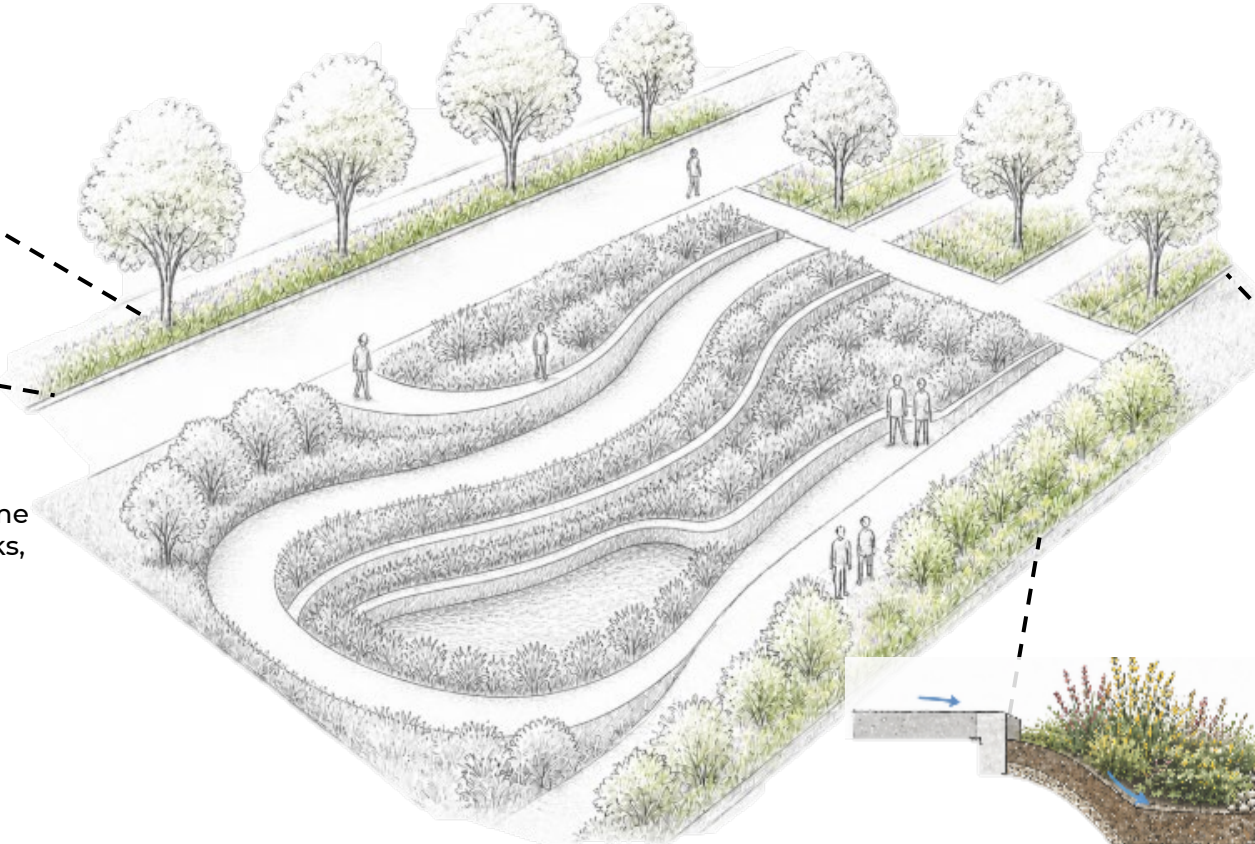

WHAT ARE BIO SWALES?

Bio swales are shallow, vegetated channels designed to capture, slow, and clean stormwater runoff. They use engineered soil and native plants to filter pollutants, promote infiltration, and reduce the volume and speed of stormwater that flows into drains, creeks, and rivers.

How They Work –

- Capture
- Filter
- Infiltrate
- Slow Release



BENEFITS

WATER QUALITY
Filters pollutants and sediments, improving downstream water quality



FLOOD MITIGATION
Reduces runoff volume and peak flows, helping prevent flooding



HABITAT CREATION
Supports native plants, pollinators, and urban biodiversity



URBAN COOLING
Adds greenery that reduces heat island effect and improves human comfort

Planting Style

Native Meadow Planting



- » Complimentary Plantings
- » Natural Plant Habits
- » Free Form Plant Clustering



High Desert Xeric Planting



- » Water Conservation
- » Adaptive Plants
- » Seasonal Interest

Conceptual Place Making

- » Baffles and Water Collection
- » Gathering Space
- » Form
- » Function
- » Reimagination of Space



Conceptual Place Making

- » Celebration of Water
- » Circulation
- » Material Usage
- » Feel of The Space
- » Breaking up Sight Lines



Conceptual Place Making

- » Gathering Spaces
- » Trails
- » Playgrounds
- » Open Space
- » Entertainment
- » Crime Prevention Through Environmental Design (CPTED)



Next Steps

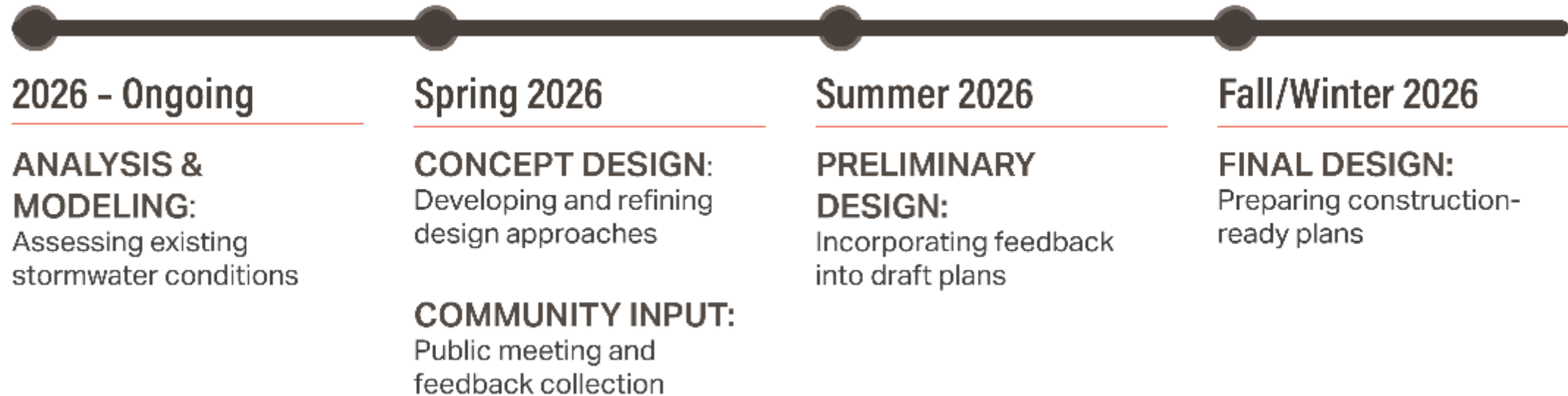

Thank You!

For any questions or comments, please contact:

Emily.Engelbart@wsp.com

Comment period closes on Sunday, June 7.